

# **SILVER SPRING ERUV ASSOCIATION, INC.**

**BOX 2635**

**SILVER SPRING, MD 20915**

ב'ס"ד

September 7, 2004

SSEA has already announced that there will be NO ERUV for Shabbat Shuvah (September 17-18) because ongoing construction has been damaging the eruv. We have had to replace ten to twenty lechis each of the past three Fridays. We cannot rely on a Wednesday inspection of the eruv. It is likely that these problems will continue at least through the end of the Yom Tov season. Therefore, you should not expect that we will have the eruv for Shabbat Chol HaMoed Sukkot or for the Shabbat after Shemini Atzeret. We will inspect the eruv for Yom Kippur.

To help you cope with the possibility of not having the community eruv for Shabbat Chol HaMoed, we have prepared the attached pamphlet which gives general guidance on how to construct an eruv for your sukkah. SSEA and our halachic advisor, Rabbi Anemer, are concerned that people will rely on the pamphlet without obtaining competent advice on specific construction of their own eruvs. There are many halachic details involved in building a kosher eruv, and it is very easy to make a mistake. We have seen a variety of errors, many of them being beyond differences in halachic opinions. Obviously, your Rabbi and the SSEA volunteers cannot be expected to go check every home eruv on the Friday before Sukkot. Nevertheless, we are making this pamphlet available through SEHC, YISE, SSJC, and KMS. We hope you will use the information wisely, with proper respect for halachah.

FROM SILVER SPRING ERUV ASS'N, INC.

9/24/90

- 
- IF YOU MAKE AN ERUV WITHIN YOUR OWN YARD, NO OTHER STEPS ARE NECESSARY
  - IF YOU MAKE AN ERUV WITH YOUR JEWISH NEIGHBOR, YOU MUST ALSO MAKE AN ERUV CHATZEROT. PROCEDURE IN BIENBAUM OR APT SCROLL SIDDUR. CHECK WITH YOUR RABBI.
  - IF YOU USE PART OF A NON-JEWISH NEIGHBOR'S YARD OR HOUSE TO MAKE AN ERUV, CHECK WITH YOUR RABBI. (THE ERUV MIGHT NOT BE VALID UNLESS YOU OBTAIN HALACHIC RIGHTS FROM THE NEIGHBOR)

# BASIC ARRANGEMENT FOR MAKING AN ERUV FOR YOUR SUCCAH

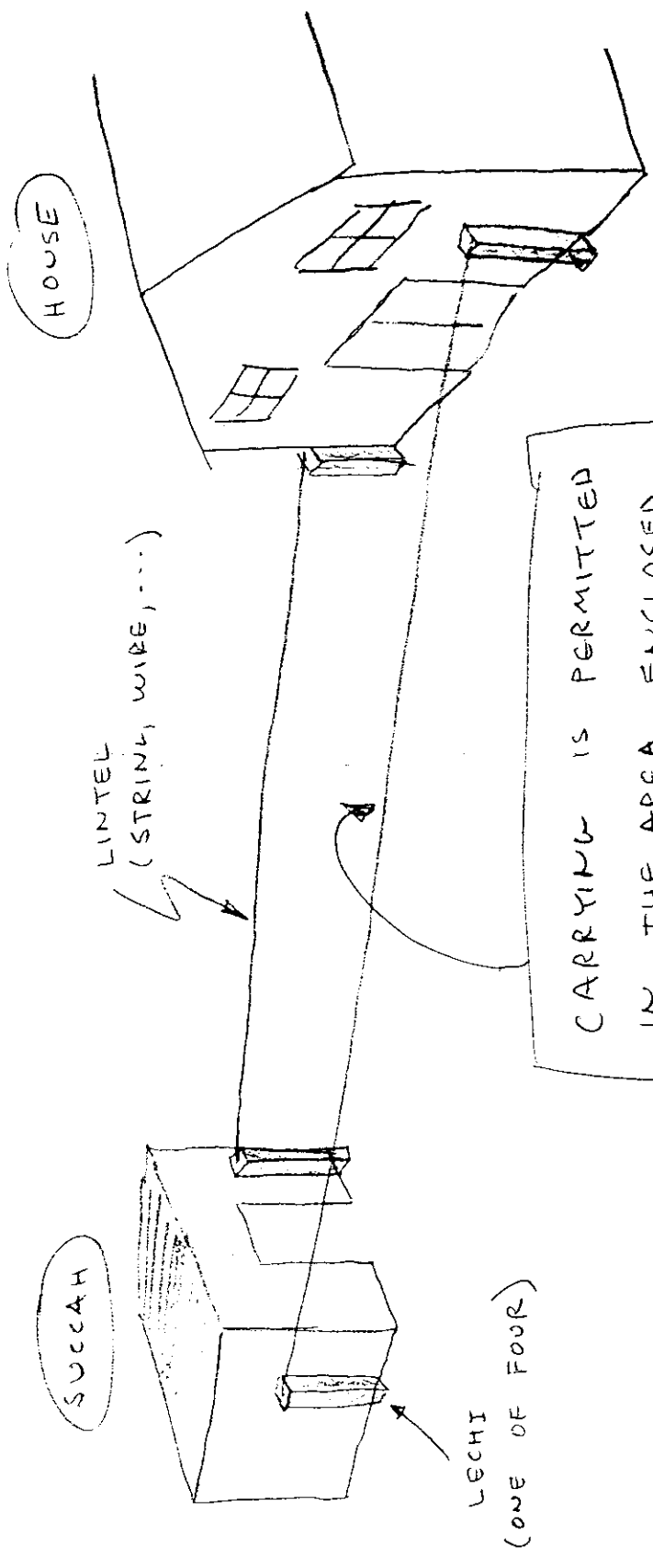

CARRYING IS PERMITTED IN THE AREA ENCLOSED BY THE HOUSE, THE SUCCAH, AND THE TWO TZURAT HA-PETACH'S (BETWEEN THE WIRES).  
 YOU MAY CARRY BETWEEN HOUSE AND SUCCAH IF YOU STAY BETWEEN THE WIRES.

# TOP VIEWS OF VARIOUS ARRANGEMENTS

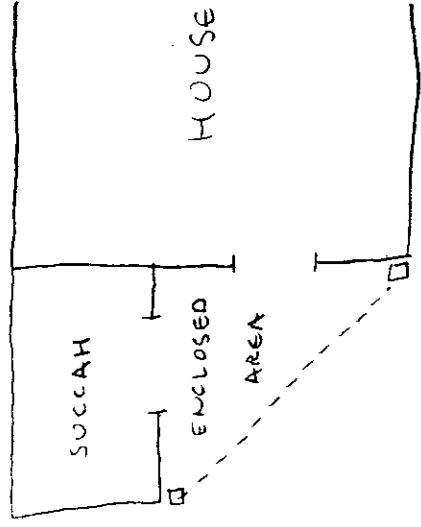
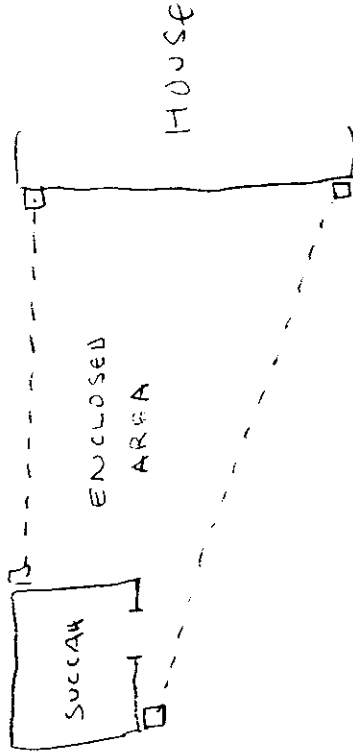
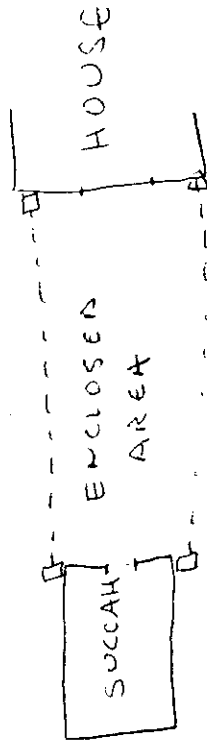
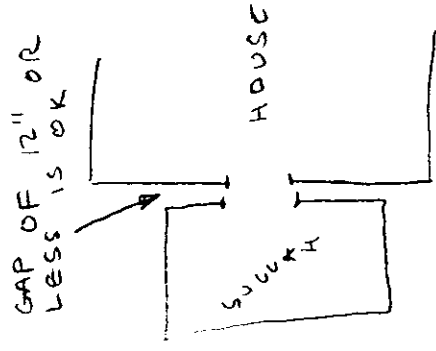

SUCCAH BUILT ON A  
DECK OR PORCH WHICH  
IS RAISED AT LEAST 40"  
ABOVE GROUND ALL  
AROUND MAY BE OK -  
CHECK WITH YOUR RABBI

## MORE TYPICAL ARRANGEMENTS

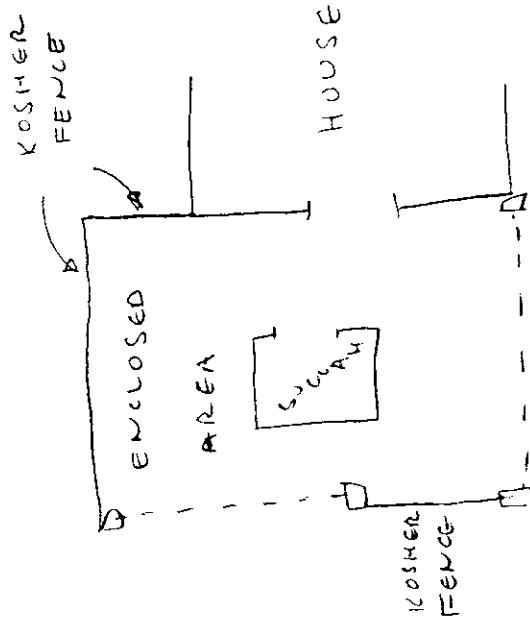
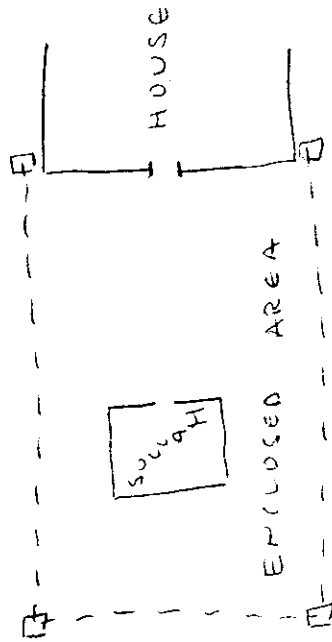

HORIZONTAL GAPS ARE MORE COMPLICATED.



## WALLS AND FENCES

- WALL OR FENCE MUST BE AT LEAST 40" TALL
  - BOTTOM MUST BE WITHIN 9" OF THE GROUND
- VERTICAL GAPS UP TO 9" ARE OK
  - PICKET FENCE MAY BE OK

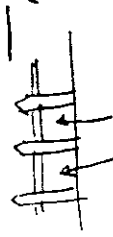

AT LEAST 40" TALL  
SPACING LESS THAN 9"

- CHAIN LINK FENCE IS OK (IF IT MEETS THE 40" AND 9" REQUIREMENTS)
- GATES ARE OK IF, WHEN CLOSED, THEY MAKE A KOSHER FENCE (BUT THEY ARE ALLOWED TO BE OPEN)
- LARGER GAPS ARE OK ONLY UNDER CERTAIN CONDITIONS - ASK YOUR RABBI

# TZURAT HA-PETACH FUNDAMENTALS

HORIZ CAN BE A BOARD, WIRE, STRING, TAPE, ...

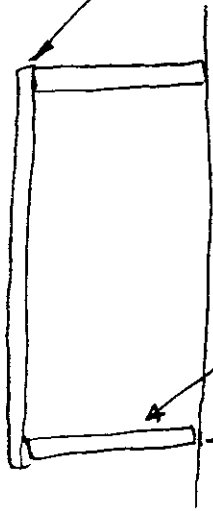

HORIZONTAL MUST GO OVER TOP OF LECHI

LECHI (BOTTOM 40") MUST BE FIRM

BOTTOM OF LECHI MUST BE WITHIN 9" OF THE GROUND

TRY TO KEEP THE WIRE/STRING CLEAR - DEFLECTIONS (HORIZONTAL OR VERTICAL) CAN POSSIBLY THE WIRE

9/17/2004

• MINIMUM HEIGHT IS 40"

• HORIZONTAL MAY SAG

• NEVER BELOW 40"

• TOTAL SAG LESS



• MUST HAVE AT LEAST 16" OPENING (WITHOUT BLOCKAGE)

BETWEEN THE LECHIS

• NO MAXIMUM HEIGHT OR WIDTH

• LECHI (BOTTOM 40") MUST BE WITHIN 9" OF THE WALL

• LECHI MAY LEAN

• LECHIS MAY BE DIFFERENT HEIGHTS IF THIS ANGLE IS LESS THAN 45°

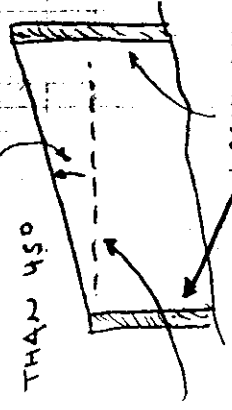

TRUE HORIZONTAL

TRY TO KEEP THE WIRE/STRING CLEAR - DEFLECTIONS (HORIZONTAL OR VERTICAL) CAN POSSIBLY THE WIRE

• IF YOU HAVE A LECHI

UNDER A FLAT ROOF (OR

SOFFIT OR CEILING), INCLUDING

S'CHACH, WHICH EXTENDS

12" OR MORE,

CHECK WITH

YOUR RABBI.

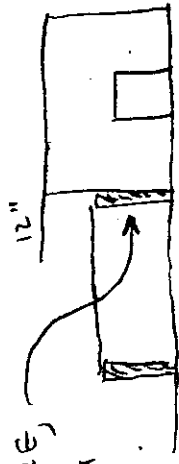

KEEPING THE STRING ON TOP OF THE LECHI

ALL THESE ARE OK

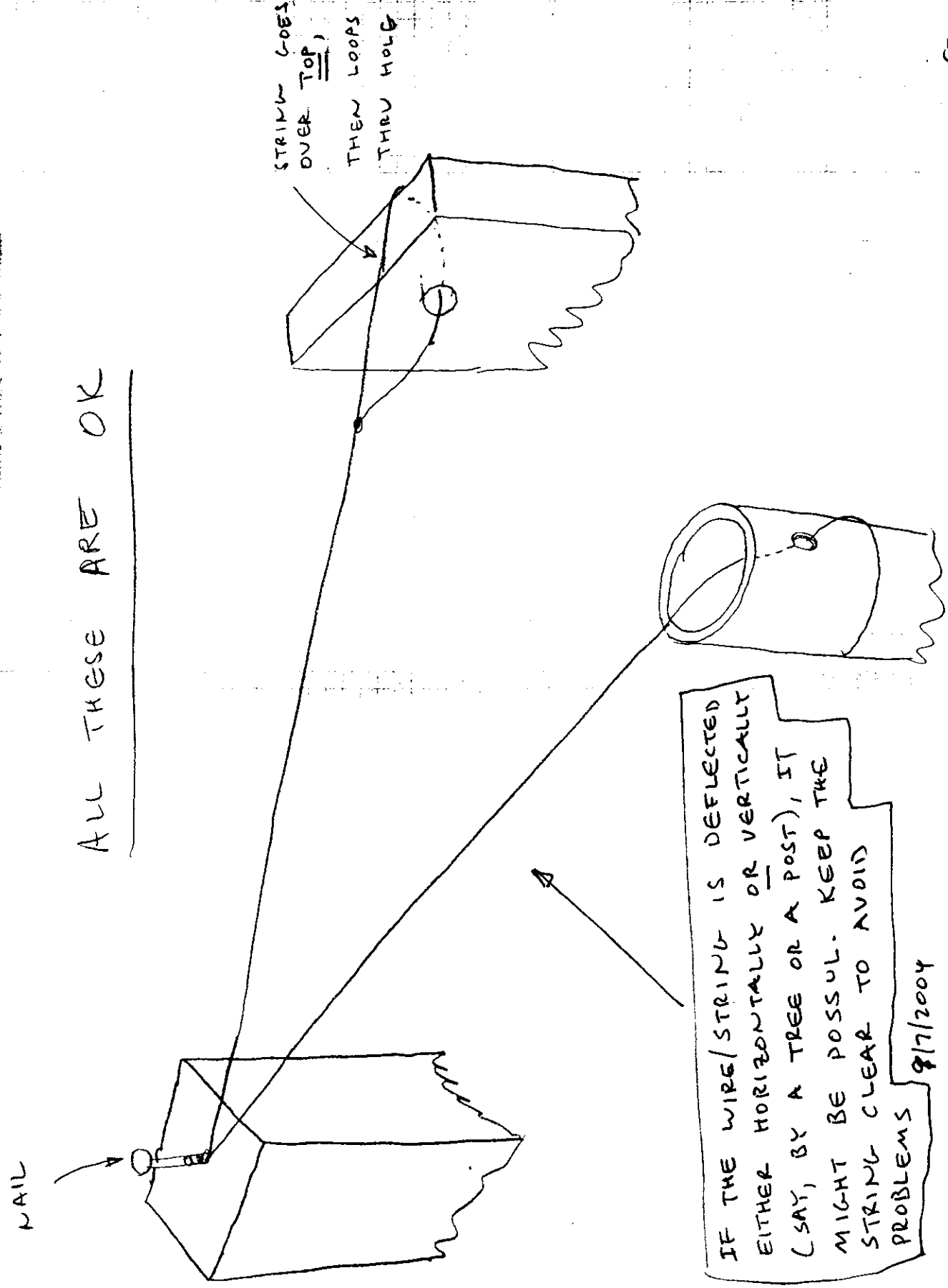

POSSUL

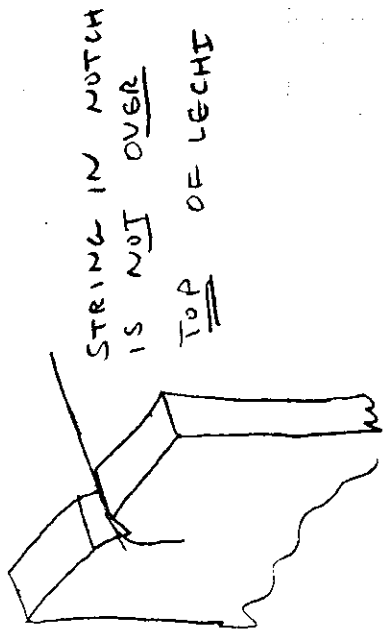

STRING IS NOT  
OVER TOP OF  
LECHI

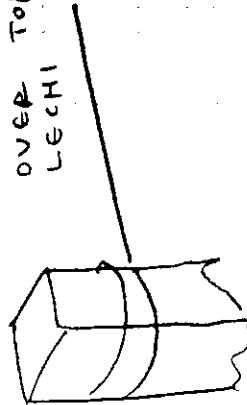

OK

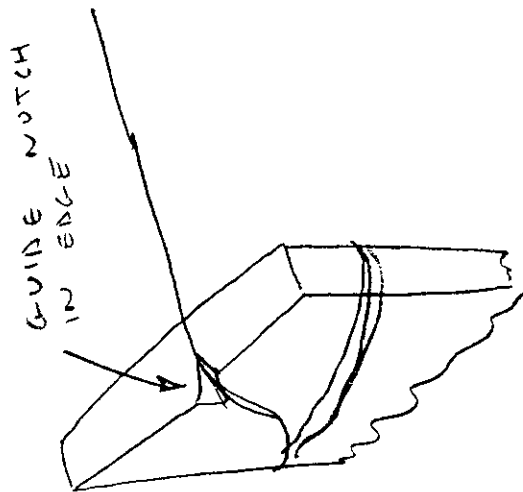



SSEA  
9/20/96

LECHI SHOULD BE DISTINCT

DO NOT USE A  
FENCE BOARD  
FOR A LECHI

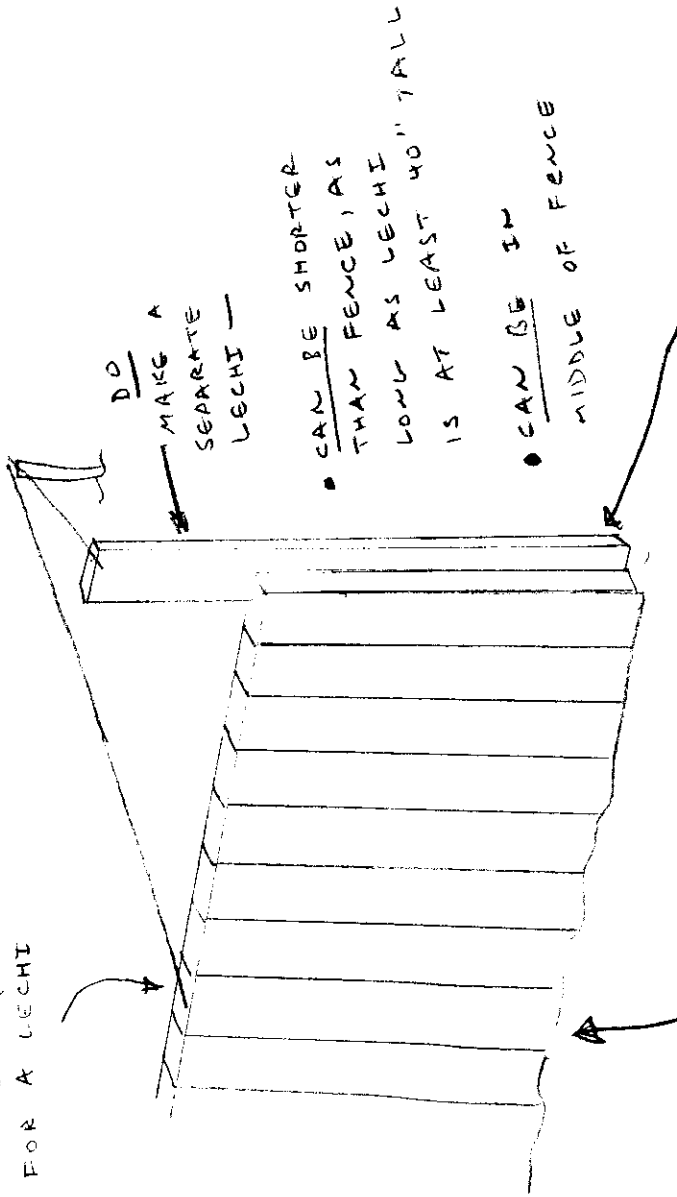

OK

POSSUL

SSEA  
9/20/96

LECHI SHOULD NOT BE SEPARATELY ENCLOSED #4

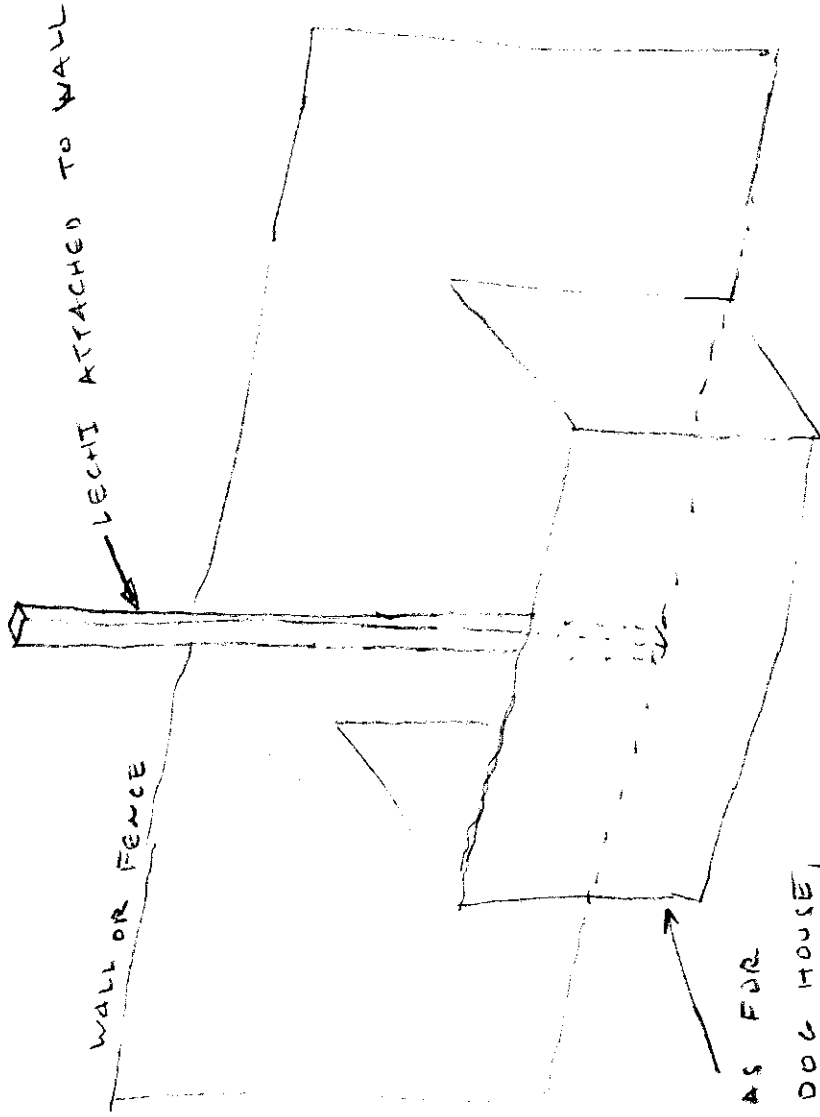

FENCE, AS FOR  
GARDEN, DOG HOUSE,  
COMPOST HEAP, OR  
WHATEVER.

POSSUL

(9)

55EA  
9/20/96

LECHT SHOULD NOT BE SEPARATELY ENCLOSED #2

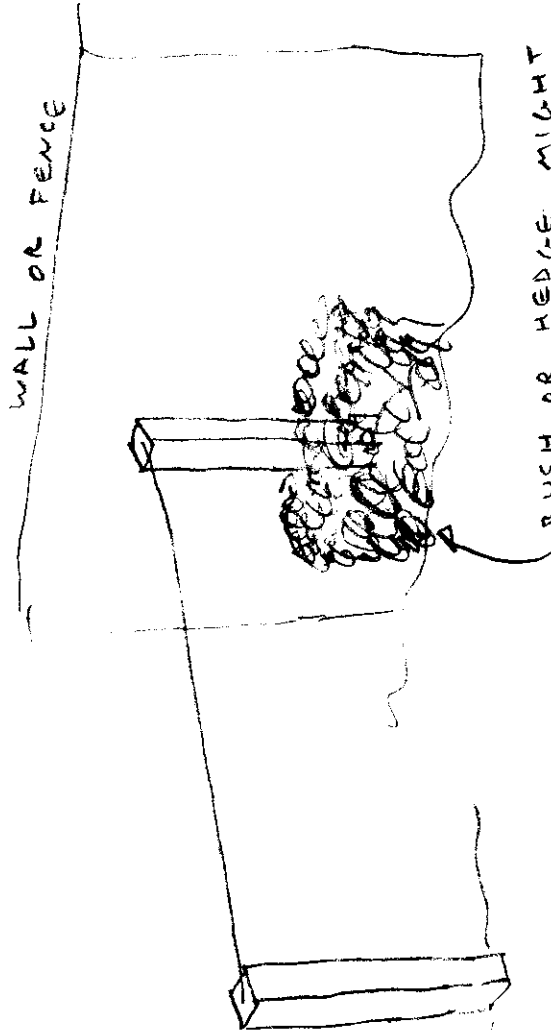

BUSH OR HEDGE MIGHT  
MAKE AN ENCLOSURE  
WITH THE FENCE

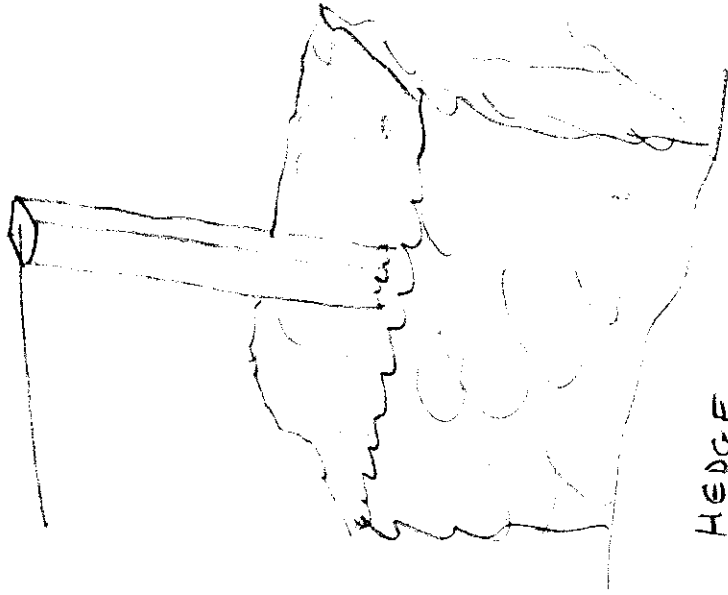

HEDGE OR BUSH  
ENCLOSES LECHT

POSSUL